

Solo Rear Rack Fitting Instructions

- Bonneville America



! WARNING: Always have Triumph approved parts, accessories and conversions fitted by a trained technician of an authorised Triumph dealer. The fitting of parts, accessories and conversions by a technician who is not of an authorised Triumph dealer may affect the handling, stability or other aspects of the motorcycle operation which may result in an accident causing injury or death.

! WARNING: This solo rack is designed for use solely on the Triumph Bonneville America and should not be fitted to any other Triumph model or to any motorcycle of other manufacturers. Fitting this solo rack to any other Triumph model or to any motorcycle of other manufacturers may interfere with the rider and could affect the stability and handling of the motorcycle leading to an accident causing injury or death.

! WARNING: Throughout this operation, ensure that the motorcycle is stabilised and adequately supported to prevent the risk of injury from the motorcycle falling.

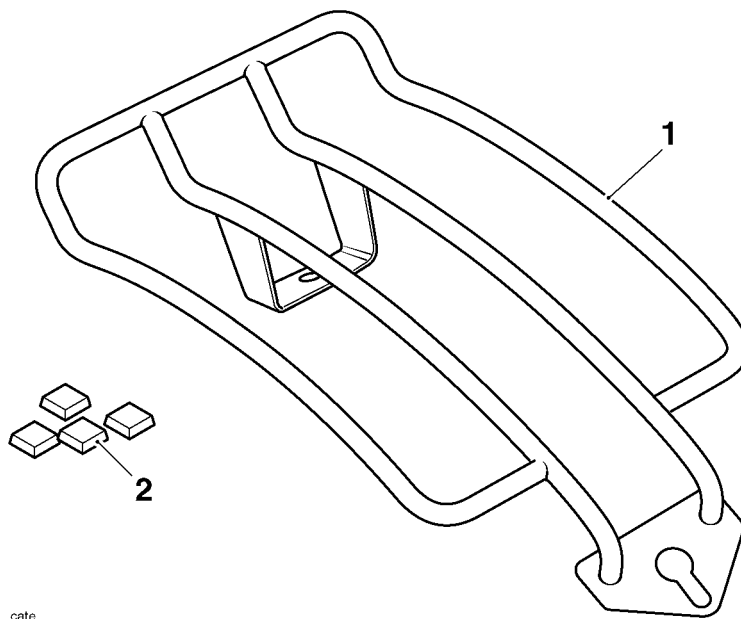

| Item | Description | Qty | Item | Description | Qty |
|------|-------------|-----|------|--------------------|-----|
| 1 | Solo rack | 1 | 2 | Self-adhesive feet | 4 |

Solo Rear Rack Fitting Instructions - Bonneville America



1. Attach the self-adhesive feet to the rack as shown to prevent damage to the paint-work.

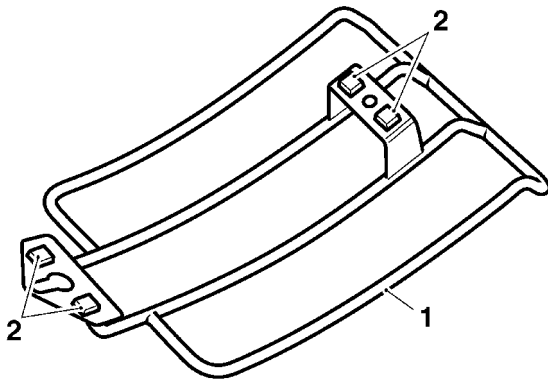

catf

1. **Rack**
2. **Adhesive feet**
2. Remove the rear seat and front seat mounting bolts.
3. Position the rack on the mudguard with the forward mounting bracket over the front seat mounting bracket. Do not tighten at this stage.

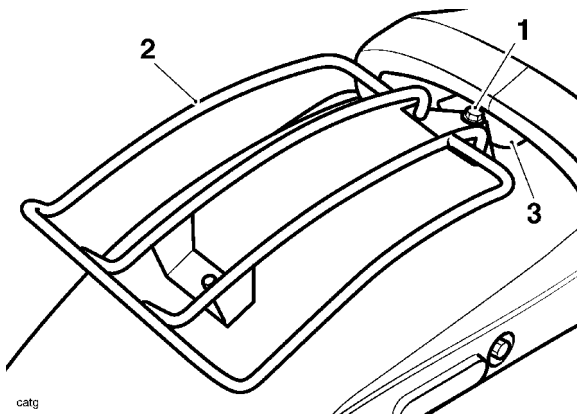

catg

1. **Bolt**
2. **Rack**
3. **Front seat mount bracket**
4. Secure the rear of the rack using the M6 rear seat bolt. Tighten to **10 Nm**.
5. Tighten the front seat mounting bolt, thus securing the rack also, to **26 Nm**.

! WARNING: The maximum load that may be carried on the luggage rack is **5 Kg (11.0 lbs)**.

! WARNING: Failure to tighten any of the fasteners to the correct torque specification may result in an accident causing injury or death.

! WARNING: The luggage rack must not be used to carry sharp objects or objects which extend beyond the extremities of the rack. Carriage of such items on the luggage rack may interfere with or distract the rider or passenger and could affect the stability and handling of the motorcycle leading to an accident causing injury or death.

! WARNING: Incorrect loading of the luggage rack may result in an unsafe riding condition leading to an accident. Always ensure any loads carried are evenly distributed on both sides of the motorcycle. Ensure that the load is correctly secured such that it will not move around while the motorcycle is in motion. Always check the load security regularly (though not while the motorcycle is in motion) and ensure that the load does not extend beyond the rear of the motorcycle. Never exceed the maximum vehicle loading weight of **200 Kg (440 lbs)**.

! WARNING: Never ride an accessory equipped motorcycle (including those fitted with Triumph approved windscreens and luggage systems) at speeds above **130km/h (80mph)**. The presence of accessories such as windscreens and luggage systems will cause changes in the stability and handling of the motorcycle. Failure to allow for changes in motorcycle stability may lead to loss of control or an accident. Remember that the **130km/h (80mph)** limit will be reduced by the fitting of non-approved accessories, incorrect loading, worn tyres, overall motorcycle condition and poor road or weather conditions.

! WARNING: The motorcycle must not be operated above the legal road speed limit except in closed course conditions.