

English

## Fitting Instructions:

### Bonneville/T100, Thruxton and Scrambler - Carburettor and Electronic Fuel Injection (EFI) models

#### A9808084

Thank you for choosing this Triumph genuine accessory kit. This accessory kit is the product of Triumph's use of proven engineering, exhaustive testing, and continuous striving for superior reliability, safety and performance.

Completely read all of these instructions before commencing the installation of the accessory kit in order to become thoroughly familiar with the kit's features and the installation process.

These instructions should be considered a permanent part of your accessory kit, and should remain with it even if your accessory-equipped motorcycle is subsequently sold.

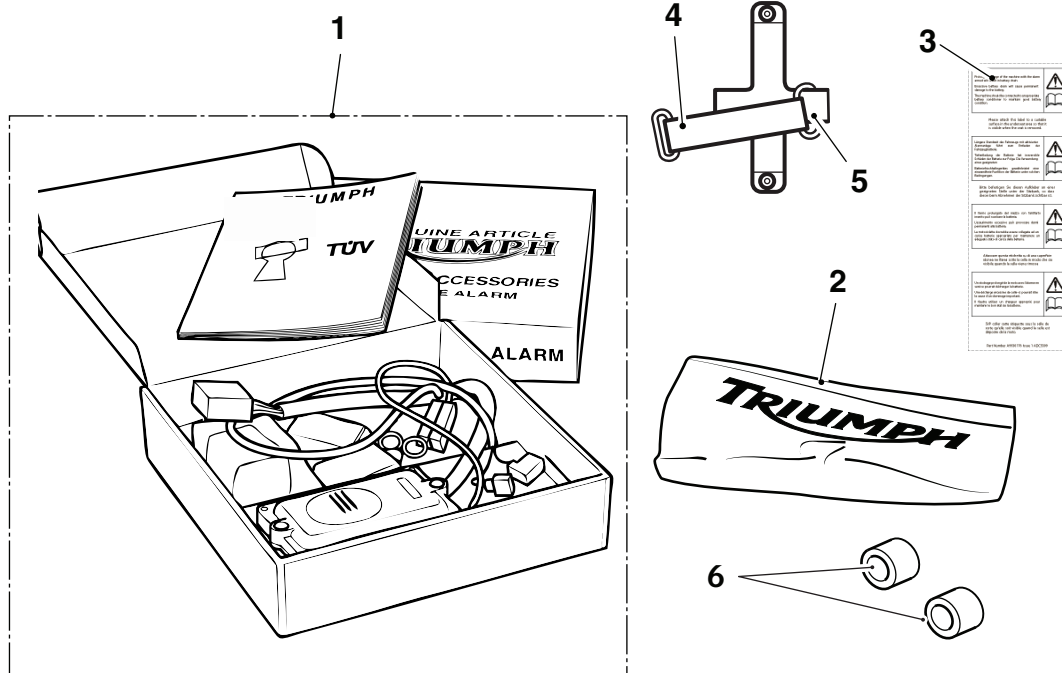

### Parts Supplied:

1.	Alarm/immobiliser	1 off	4.	Strap	1 off
2.	Fitting kit	1 off	5.	Bracket	1 off
3.	Battery drainage label	1 off	6.	Spacer	2 off



## Warning

This accessory kit is designed for use on Triumph Bonneville/T100, Thruxton and Scrambler motorcycles only and should not be fitted to any other Triumph model or to any other manufacturer's motorcycle. Fitting this accessory kit to any other Triumph model or to any other manufacturer's motorcycle, may interfere with the rider and could affect the stability and handling of the motorcycle leading to loss of control and an accident.



## Warning

Always have Triumph approved parts, accessories and conversions fitted by a trained technician of an authorised Triumph dealer. The fitment of parts, accessories and conversions by a technician who is not of an authorised Triumph dealer may affect the handling, stability or other aspects of the motorcycle's operation which may result in loss of motorcycle control and an accident.



## Warning

Throughout this operation, ensure that the motorcycle is stabilised and adequately supported on a paddock stand to prevent risk of injury from the motorcycle falling.

### Note:

- **Record the serial number and tag number from the underside of the alarm unit onto the alarm installation certificate.**
  - **Once the alarm/immobiliser has been fitted, it will become an integral part of the motorcycle and cannot be removed.**
1. If the motorcycle's speedometer has the alarm status indicator in it, the LED light in the kit does not need to be fitted.  
If the speedometer does not have the alarm status indicator in it, continue from step 2.  
If the speedometer has the alarm status indicator in it, continue from step 15.

### LED Fitment

2. Undo the two screws located under the rear of the seat and remove the seat.
3. Disconnect the battery, negative (black) lead first.

4. Unscrew the four bolts securing the instrument housing.

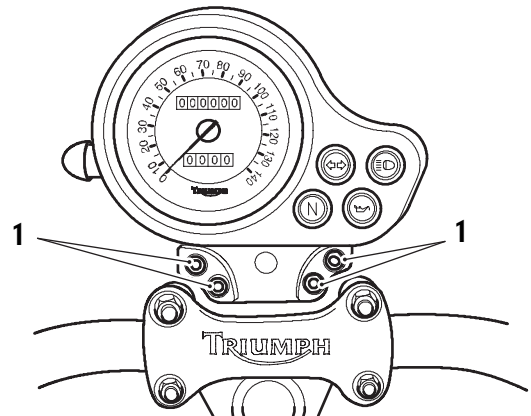

### 1. Instrument housing bolts (Bonneville)

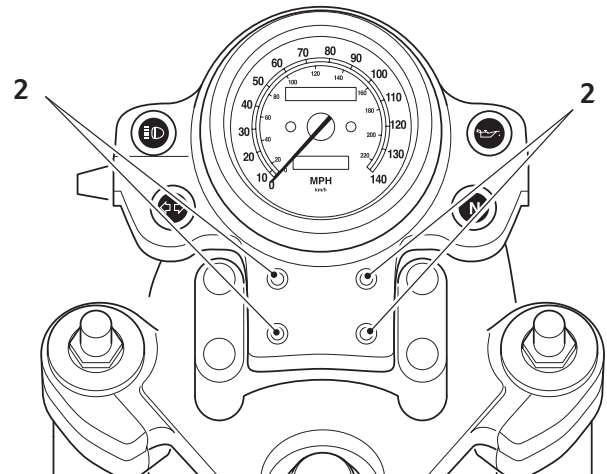

### 2. Instrument housing bolts (Scrambler)

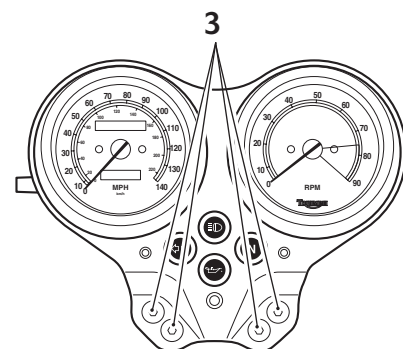

### 3. Instrument housing bolts (Bonneville T100 and Thruxton)

5. Unscrew the retaining ring and detach the cable from the speedometer.

6. **Bonneville, Bonneville T100 and Thruxton only** - Undo the two screws and remove the warning light bulb cover from the base of the instrument housing.

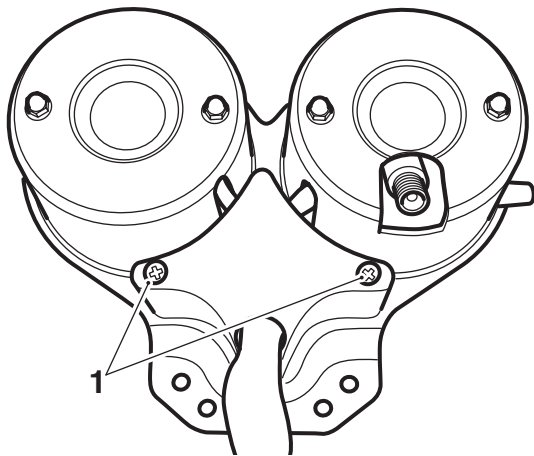

cdye

1. **Warning light bulb cover screws (Bonneville T100 and Thruxton)**

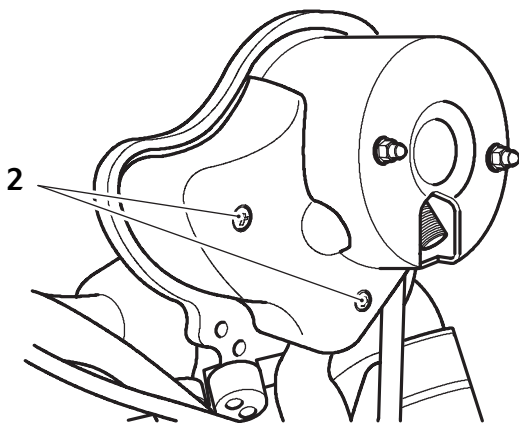

2. **Warning light bulb cover screws (Bonneville)**

7. **Scrambler only** - Undo the two domed nuts and remove the instrument cover from the instrument housing.

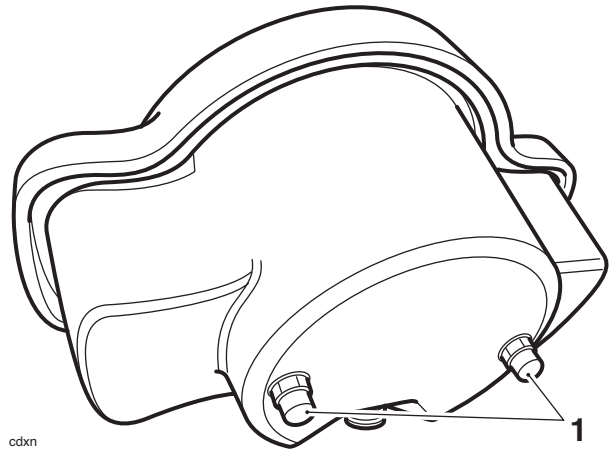

cdxn

1. **Instrument cover nuts (Scrambler)**

8. **All models** - Remove the blanking plug from the instrument housing, feed the LED from the kit through the blanking plug hole and secure with its shroud.

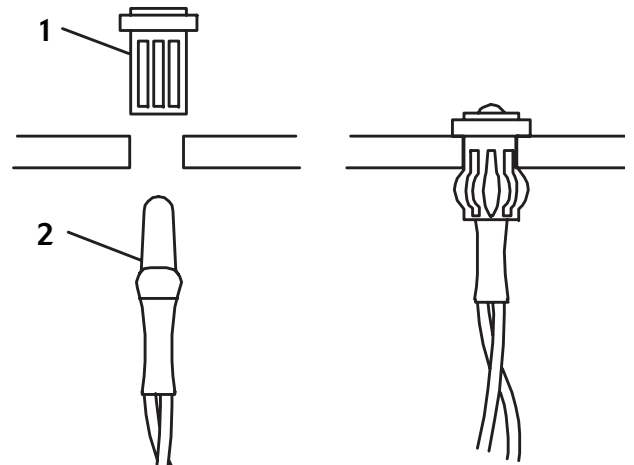

1. **Shroud**

2. **LED**

9. Connect the LED wiring to the wiring connector found under the instrument/warning light bulb cover.
10. **Bonneville, Bonneville T100 and Thruxton only** - Refit the warning light bulb cover and secure with the two screws.
11. Refit the instrument housing tightening the four bolts to **9 Nm**.
12. **Scrambler only** - Refit the instrument cover and secure with the two domed nuts.
13. Refit the instrument housing tightening the four bolts to **7 Nm**.
14. **All models** - Reconnect the cable to the speedometer and tighten its retaining ring securely.

## Alarm Unit Fitment

### Note:

- For models built from VIN 463262, the spacers provided in the kit must be used.
  - For models built up to VIN 463261, the spacers in the kit are not required.
15. For models built from VIN 463262 only: Recover the alarm bracket, the two well nuts, the two spacers and the two M5 x 20 mm screws from the kit. Insert the M5 x 20 mm screws through the bracket, fit the spacers and loosely screw on the well nuts as shown.

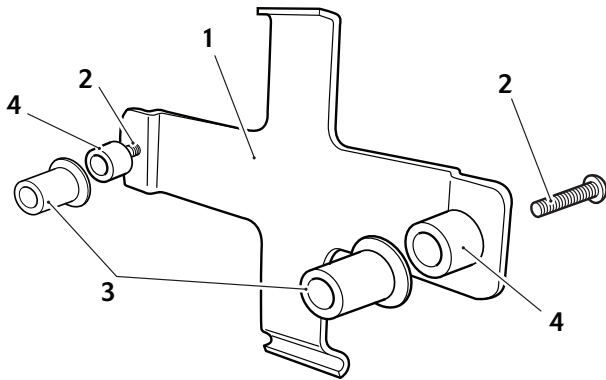

1. Alarm bracket
2. M5 x 20 mm screw
3. Well nut
4. Spacers

16. For models built up to VIN 463261 only: Recover the alarm bracket, the two well nuts and the two M5 x 20 mm screws from the kit. Insert the M5 x 20 mm screws through the bracket and loosely screw on the well nuts as shown.

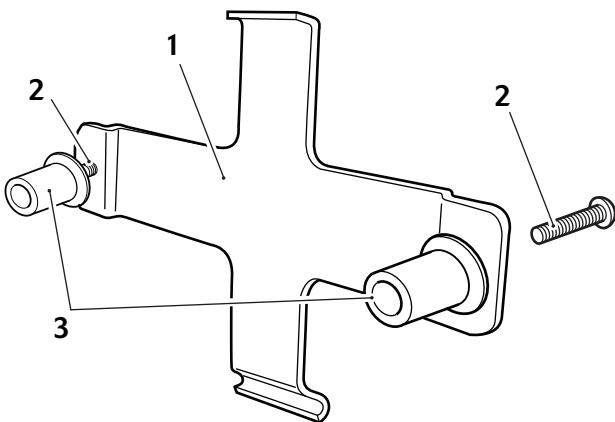

1. Alarm bracket
2. M5 x 20 mm screw
3. Well nut

17. Ensure the alarm bracket is positioned such that the raised hook shown below is positioned to the front of the motorcycle, above the battery.

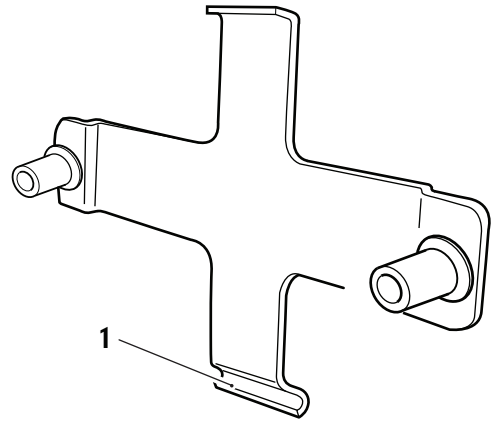

### 1. Raised hook - position to front of motorcycle

18. Align the well nuts with the frame holes and seat the alarm bracket together with the alarm unit rubber strap as shown. Tighten the M5 x 20 mm screws to 3 Nm.

### Note:

- Carburettor model shown, EFI models similar.

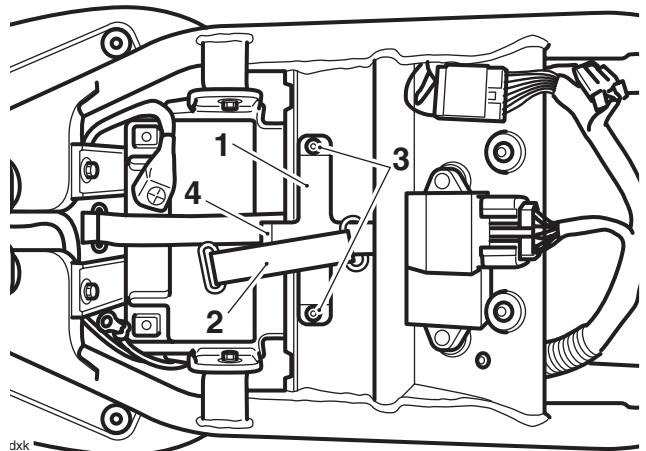

dxk

1. Alarm bracket
2. Alarm unit strap
3. M5 x 20 mm screws
4. Raised hook

### Note:

- Carburettor model shown, EFI models similar.

19. Secure the alarm unit to the bracket using the alarm strap.

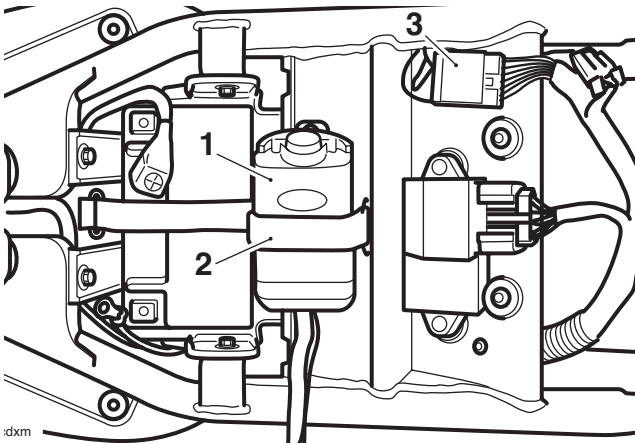

1. Alarm unit  
2. Alarm unit strap  
3. Alarm harness connector

20. Locate the black coloured, twelve-pin, alarm harness connector and remove the harness shorting plug.

**Note:**

- The alarm harness connector is an unused, black coloured terminal block. The harness shorting plug is the cover for this terminal block which is fitted with a double hoop of black cable.
  - The harness shorting plug must be returned to DATATOOL along with the registration documentation.
21. Slide the supplied heat shrink tubing over the alarm/immobiliser connector. Do not shrink the tubing at this time.

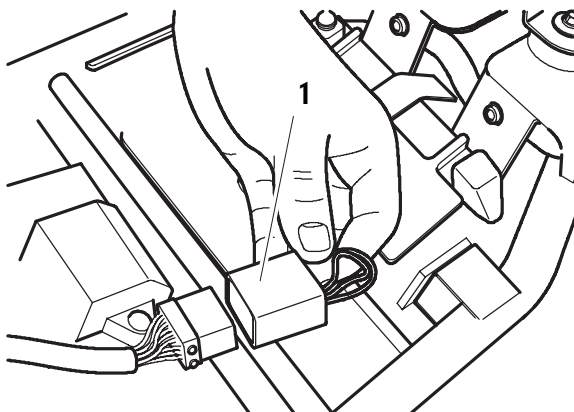

1. Harness shorting plug

22. Connect the alarm wiring connector to the alarm harness connector.

**Microswitch Fitment**

23. Bend the microswitch lever as shown in the illustration below.

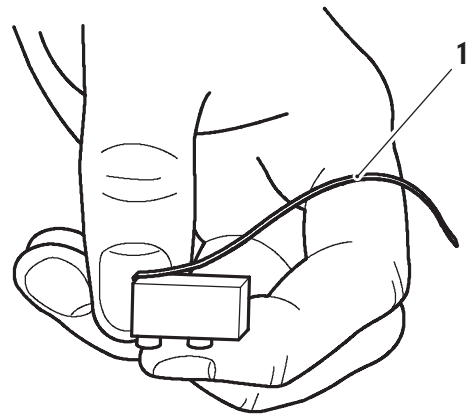

1. Correct shape of microswitch lever

**Note:**

- Read the warning notices printed on the cleaning wipe packet in the fitting kit.
  - The surface of the frame must be clean and dry to ensure that the adhesive has a sound base to adhere to. Use the cleaning wipe supplied for this purpose.
  - Maximum opening displacement of the seat to generate an alarm condition shall be 20 mm.
24. Remove the protective tape from the adhesive pad on the microswitch and position the microswitch on the frame as shown. Press firmly to secure the switch in position and connect the switch to the alarm unit.

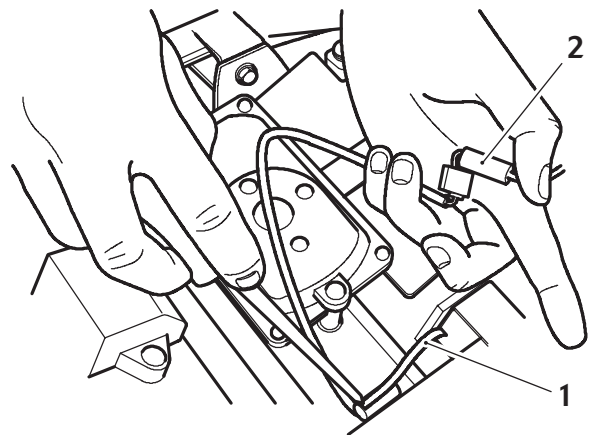

1. Microswitch  
2. Wiring connector

**! Caution**

Do not attempt to reposition the microswitch as this will destroy the adhesive qualities of the mounting pad.

25. Refit the seat and ensure the microswitch closes (if working correctly a slight click can be heard as the lever is pressed by the seat, operating the switch). If necessary, adjust the shape of the microswitch lever.
26. Remove the seat and reconnect the battery, positive (red) lead first then refit the seat ensuring that no wires are trapped between the seat and the frame.
27. Check all the functions of the alarm as detailed in the user manual.

**Note:**

- **When satisfied that the alarm/immobiliser is functioning correctly, the connection between the alarm/immobiliser unit and the main wiring harness must be made secure and tamper proof with the heat shrink tubing.**
28. Remove the seat, disconnect the battery, negative (black) lead first and remove the battery from the motorcycle.

30. Remove the fir tree clip from the right hand side of the frame and fit the retaining clip provided. Route the alarm wiring safely and tidily and secure in position with the retaining clip and cable ties provided.

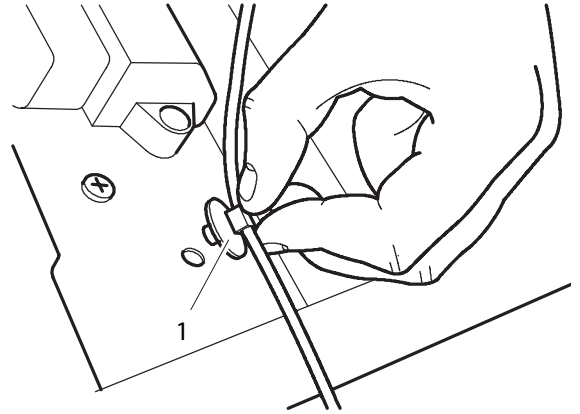

**1. Retaining clip**

31. Refit and reconnect the battery, positive (red) lead first.
32. Attach the sticker supplied with the alarm to the underside of the seat.
33. Refit the seat and tighten its screws to **10 Nm**.

 <b>Warning</b>
<p>To prevent the risk of the battery exploding and to prevent damage to electrical components ensure that the battery is removed from the motorcycle prior to the use of the heat gun.</p> <p>Failure to observe the above warnings may lead to electrical damage and a fire hazard which could cause personal injury.</p>

 <b>Warning</b>
<p>The air from the heat gun and the heat gun itself are very hot. Wear suitable protective gloves and do not point the heat gun at any part of your body as serious burns to the skin may result.</p>

 <b>Caution</b>
<p>When fitting the heat shrink tubing, take care not to burn any part of the wiring harness or serious damage will result to the cable. Excessive heat will also cause the tubing to become brittle rendering it useless.</p>

29. Using a heat gun, shrink the tubing to secure the connection.

**Note:**

- **If required, use cable ties to secure both ends of the heat shrink tubing.**

---

## Kit Contents List

- |                                |       |
|--------------------------------|-------|
| 1. Adhesive backed microswitch | 1 off |
| 2. Cable ties                  | 5 off |
| 3. Isopropanol wipe            | 1 off |
| 4. Heat shrink tubing          | 1 off |
| 5. M5 x 20 mm screws           | 2 off |
| 6. Well nuts                   | 2 off |
| 7. Lanyard                     | 1 off |
| 8. LED (including shroud)      | 1 off |
| 9. Key conversion fillet set   | 1 off |
| 10. Cable tie retaining clip   | 1 off |



### Warning

If, after fitment of this accessory kit, you have any doubt about the performance of any aspect of the motorcycle, contact an authorised Triumph dealer and do not ride the motorcycle until the authorised dealer has declared it fit for use. Riding a motorcycle when there is any doubt as to any aspect of the performance of the motorcycle may result in loss of control of the motorcycle leading to an accident.



### Warning

The motorcycle must not be operated above the legal road speed limit except in closed-course conditions.



### Warning

Only operate this Triumph motorcycle at high speed in closed-course on road competition or on closed-course racetracks. High speed operation should only be attempted by riders who have been instructed in the techniques necessary for high speed riding and are familiar with the motorcycle's characteristics in all conditions.

High speed operation in any other circumstances is dangerous and will lead to loss of motorcycle control and an accident.